

SBB 2" V3 Reference manual

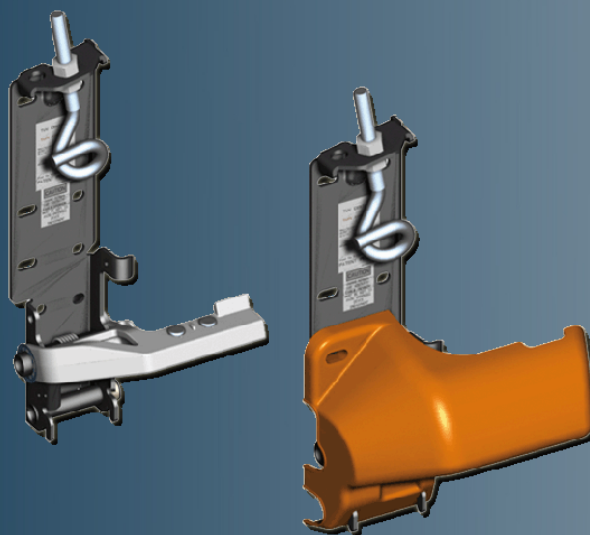

SAFETY INSTRUCTIONS



WARNING

Read this manual carefully before starting any installation, maintenance or uninstallation of safety devices. Garage door components are under high tension and may cause serious injuries.



WARNING

Only a qualified and experienced overhead door technician should work on a garage door and install or uninstall garage door devices.



WARNING

If there is a failure of any component on the garage door, the door will not work under normal conditions and must not be operated (manually or motor operated). Refer to the uninstallation instructions at the end of this document.



WARNING

Do not stand under or near an open garage door.



CAUTION

The SBB can only be installed on approved tracks (see page 11). In order to guarantee the good functioning of the SBB, the space between the bottom section of the door and the vertical track has to be in accordance with the figure on page 11 of this document.



CAUTION

During normal use, adequate cable tension must be kept to avoid undesired device engagement.



CAUTION

If the door is motor operated without soft start, then the door speed must not exceed 0.3 m/s (12 inches/s).



CAUTION

Minimum panel thickness must be used to allow proper function of the SBB (See page 11).

NOTICE

Considerable forces are generated when the system is activated to prevent the door from falling. The door section area where the system is fixed must provide proper strength to the screws attachment. The SBB must be attached properly to the door panel in order to support 4 times the door's weight. Refer to page 12 for the screwing pattern of the SBB.

SAFETY INSTRUCTIONS

NOTICE

A limit switch has to be installed if the door is motor operated. This limit switch will stop the motor in the case where the safety device is engaged. Contact your operator manufacturer for wiring diagram and type of limit switch regarding operator's needs.

NOTICE

The SBB has to be installed on both lifting cables.

NOTICE

Nothing must exceed the front of the track at any position.

THIS PRODUCT IS LABORATORY TESTED. NOTE THAT PERFORMANCE OF THIS PRODUCT COULD VARY DEPENDING ON DOOR MANUFACTURER, INSTALLATION OR CONDITIONS OF USE.

COMPONENTS

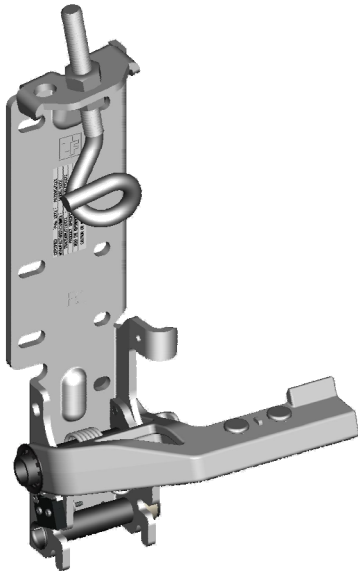
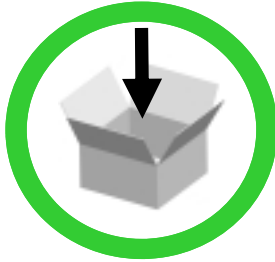

1 X **1** L
1 X **1** R

1 X **2** L
1 X **2** R

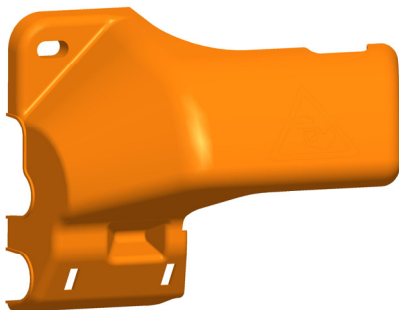

2 X **3**

2" (46 mm) with a 7/16" (11 mm) shaft

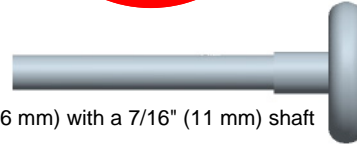

20 X **4**

6.3 X 35 mm - 1/4-20 X 1:3/8"

OR



2 X **5**

3/16" - 5 mm max cable diameter

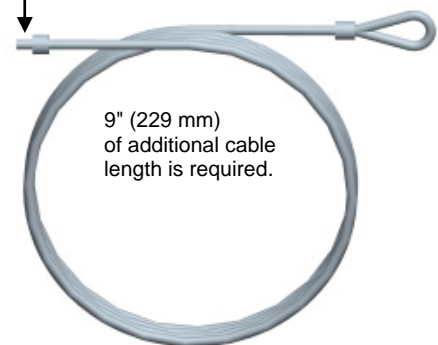

9" (229 mm)
of additional cable
length is required.

2 X **6**

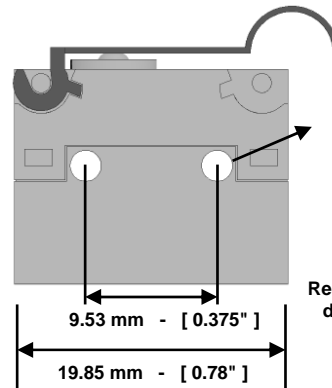

2 X Ø 2.25 mm
[0.089"]

Recommended
dimensions

9.53 mm - [0.375"]
19.85 mm - [0.78"]

4 X **7**



M2 X 12 mm - # 2-56 X 1/2"

4 X **8**



M2 - # 2-56

INSTALLATION GUIDE

1

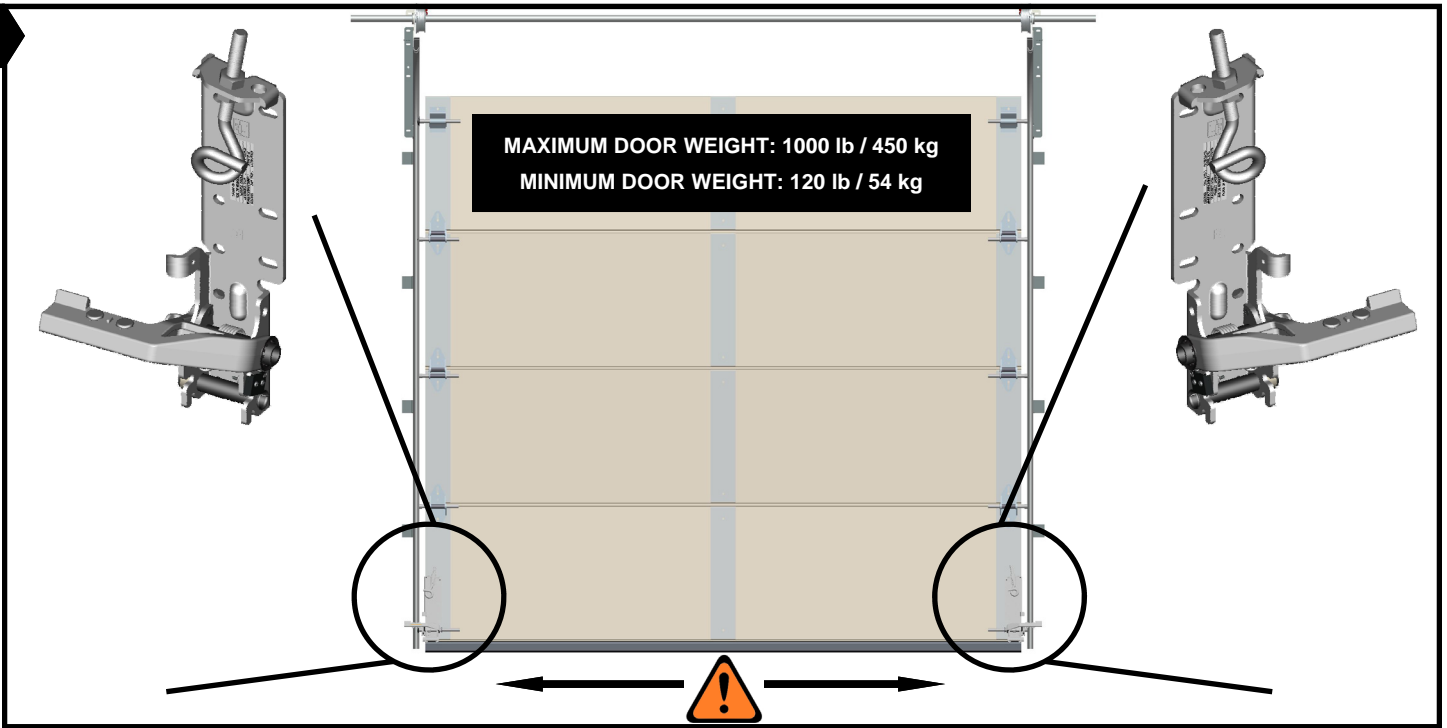

2



3

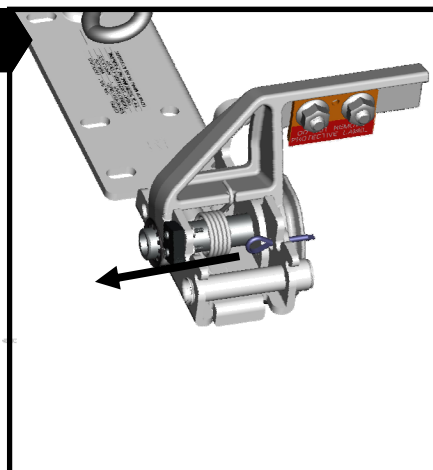

4

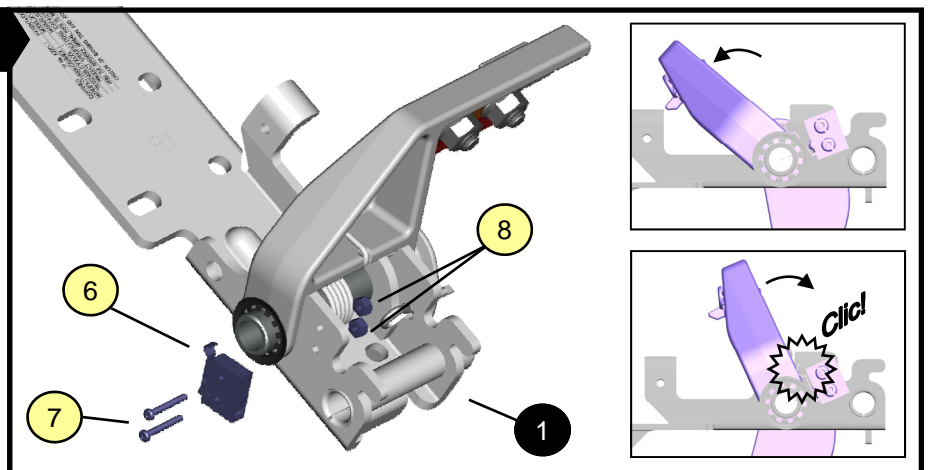

INSTALLATION GUIDE

5

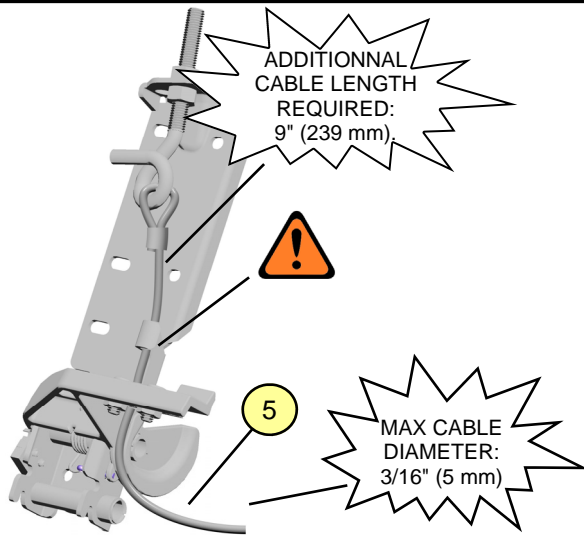

6

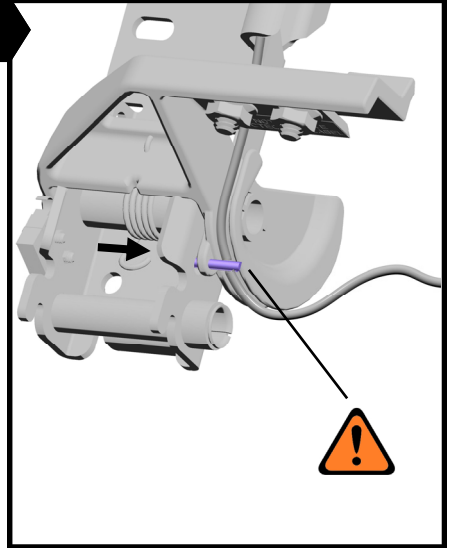

7

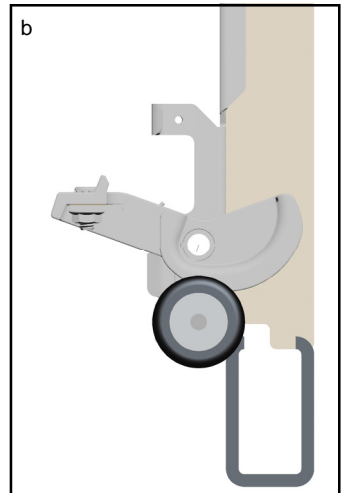
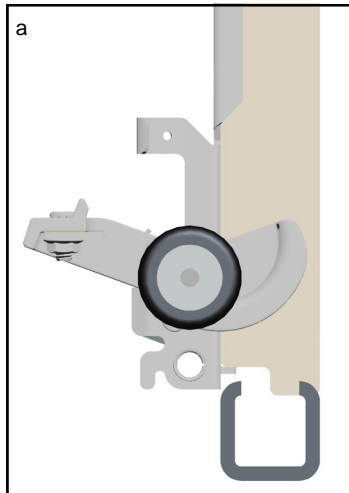
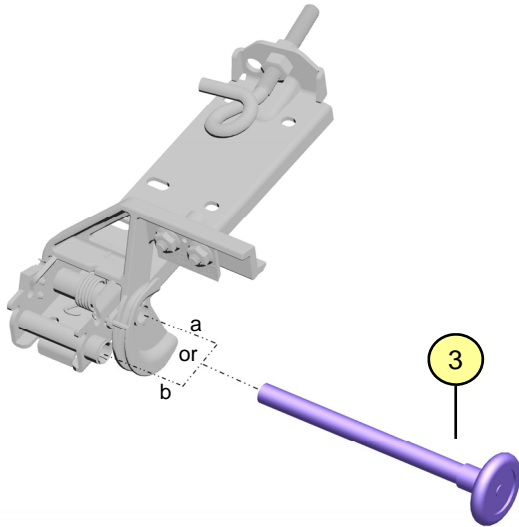

8

To be installed at step 14

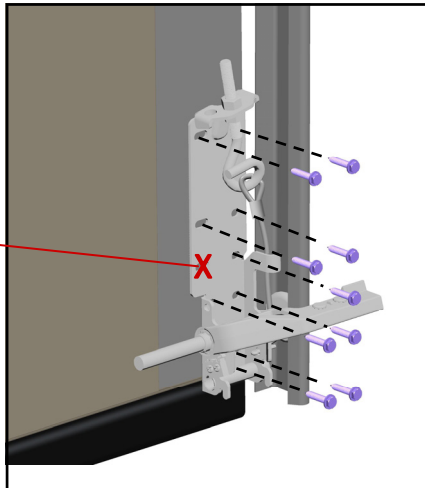

INSTALLATION GUIDE

9

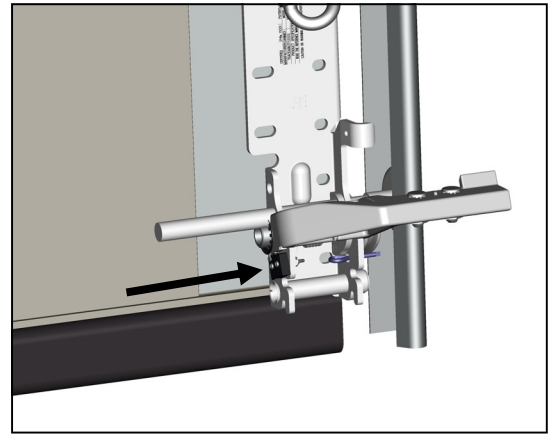
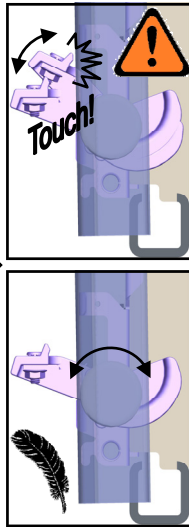
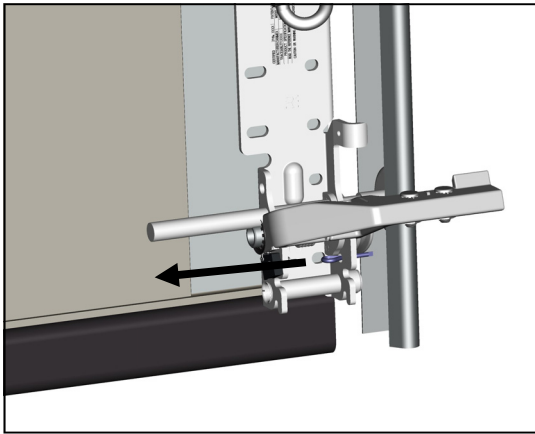

10

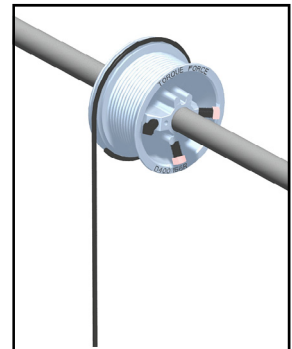
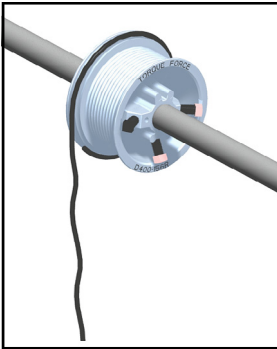

11

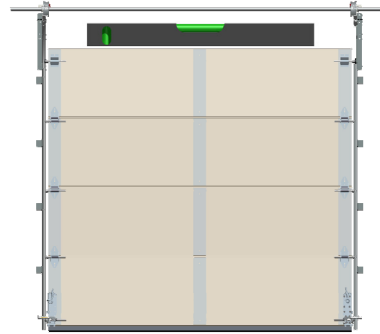
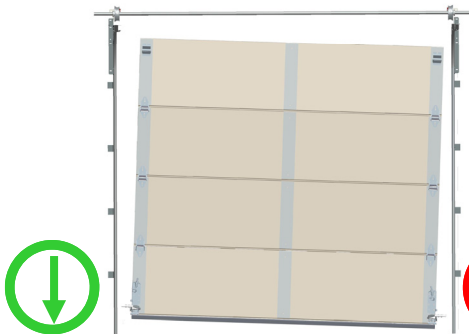

Do not
lift the door

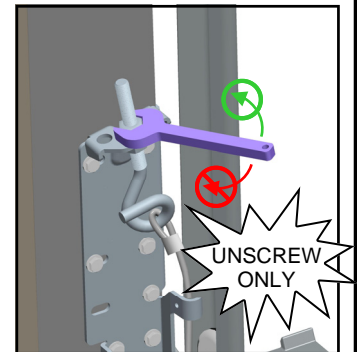

CAUTION

Do not try to lift the door using the cable adjustment bolt.

INSTALLATION GUIDE

12

IMPORTANT

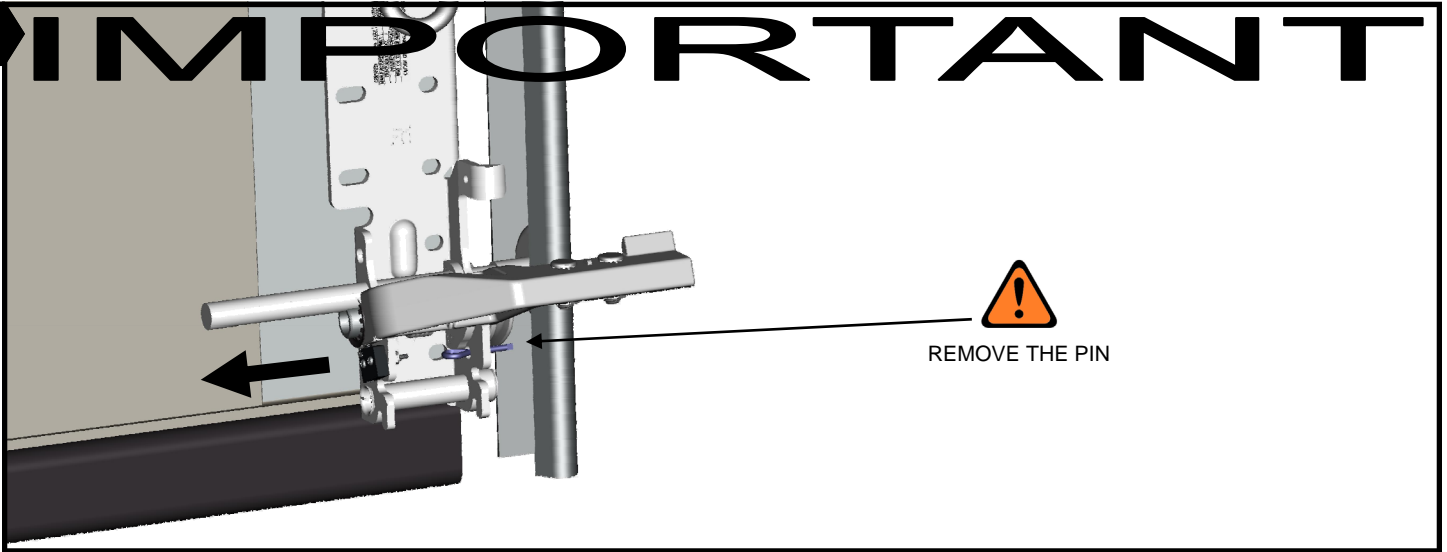

13

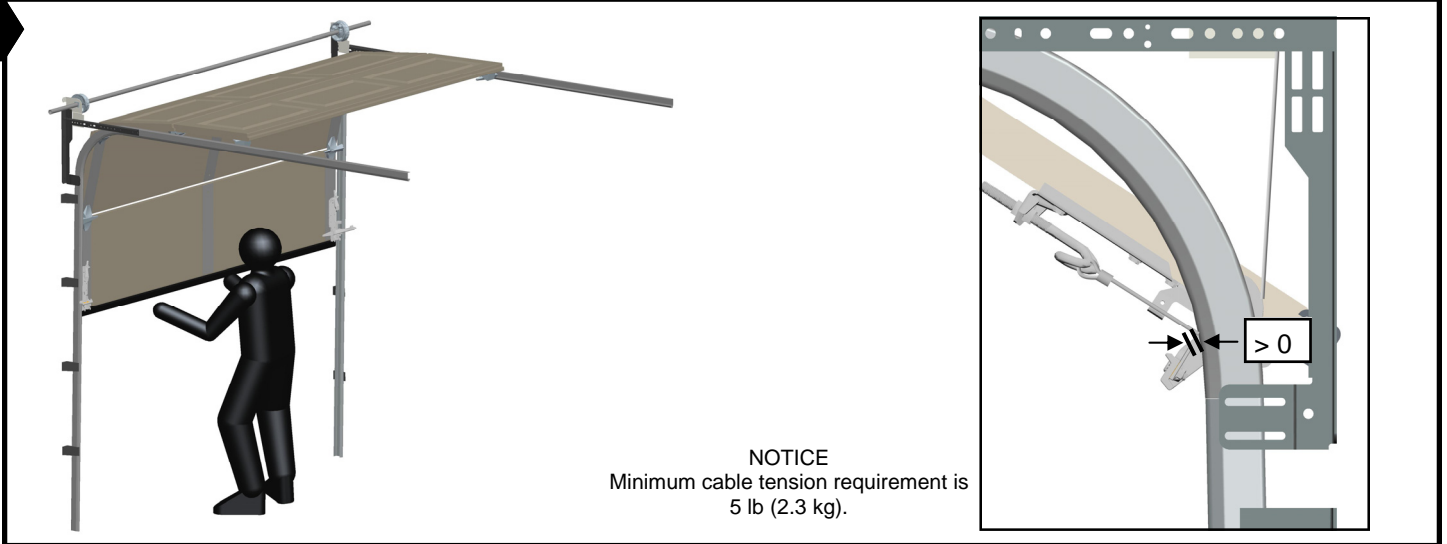

14

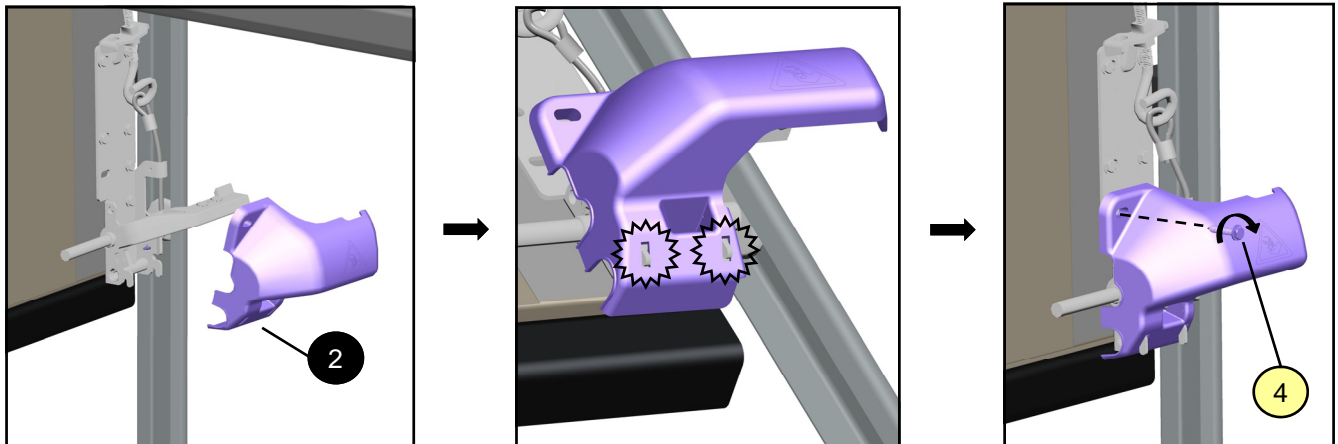

METHOD OF OPERATION

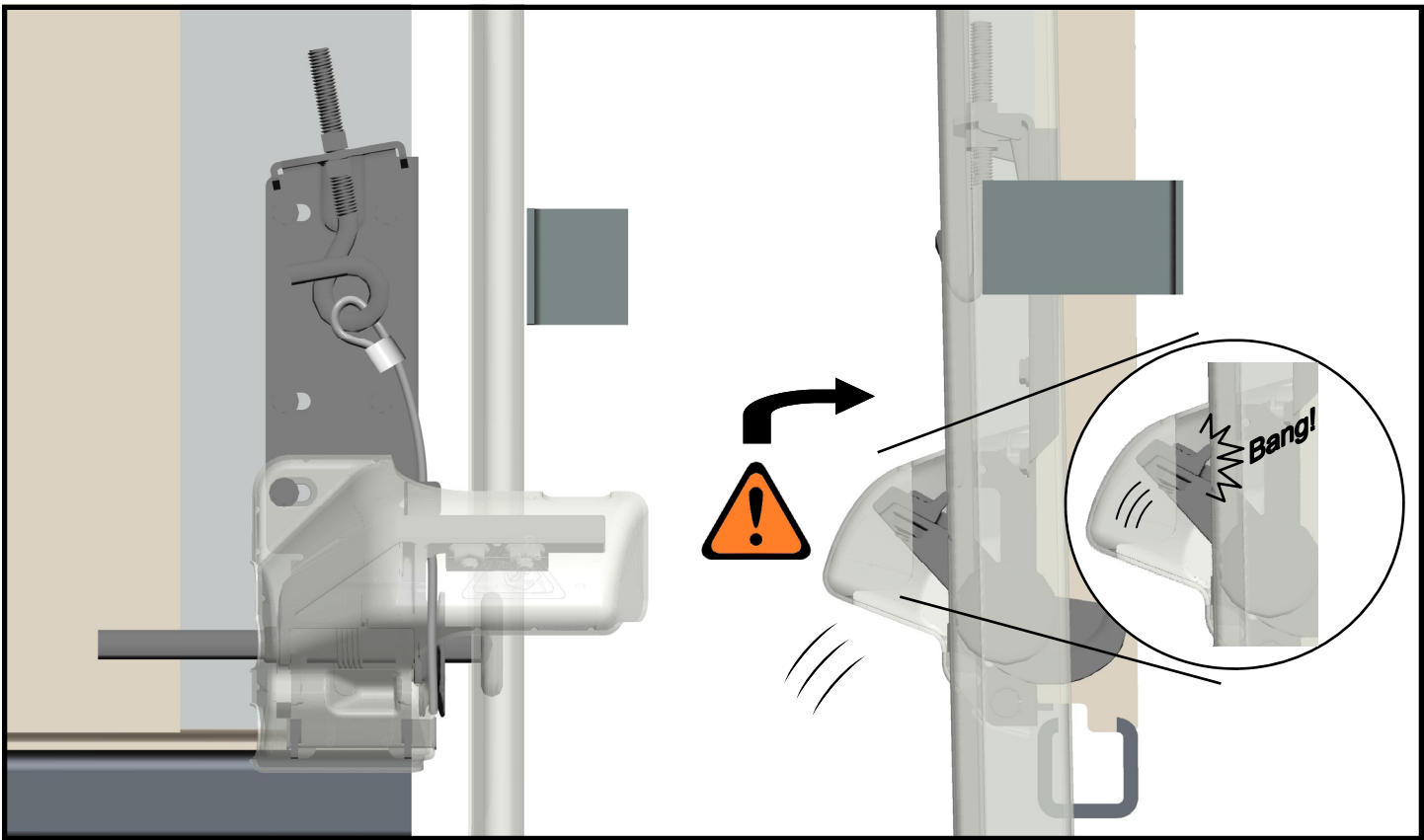
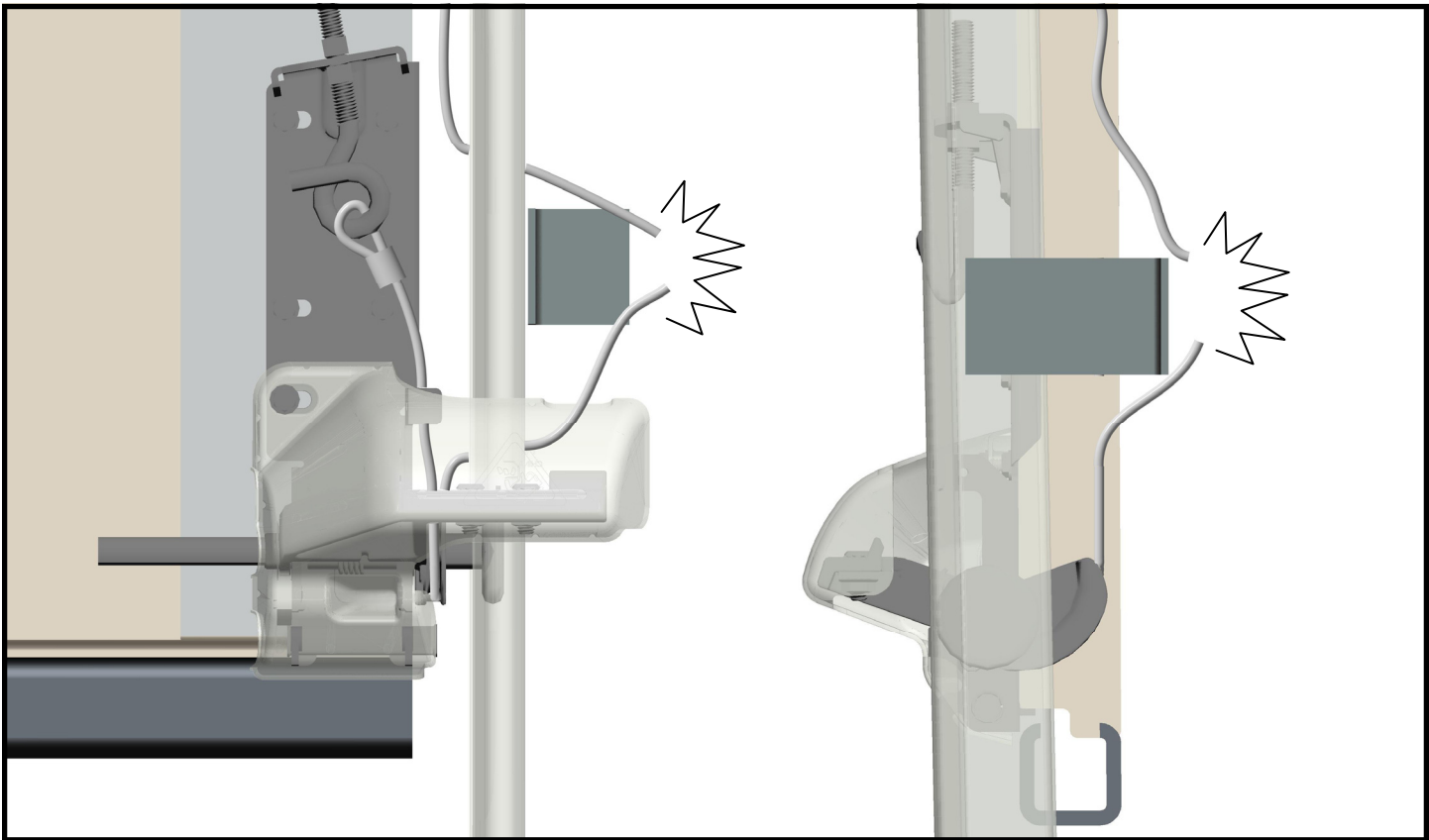

OPTIONAL COMPONENTS

SBB 2" V3 LOCK KIT

CANIMEX PART NUMBER: 181454

APPLICATION: This SBB 2" V3 LOCK KIT, when combine with one of our SBB 2" V3 model, offers a burglar resistance for jack shaft or chain hoist operated doors.

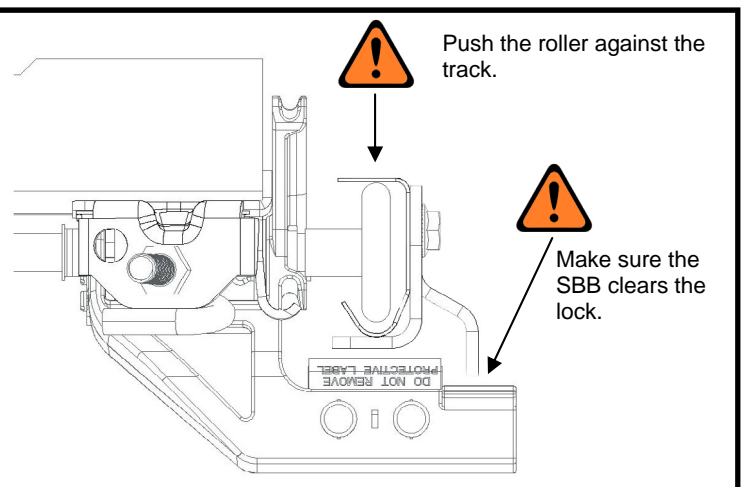
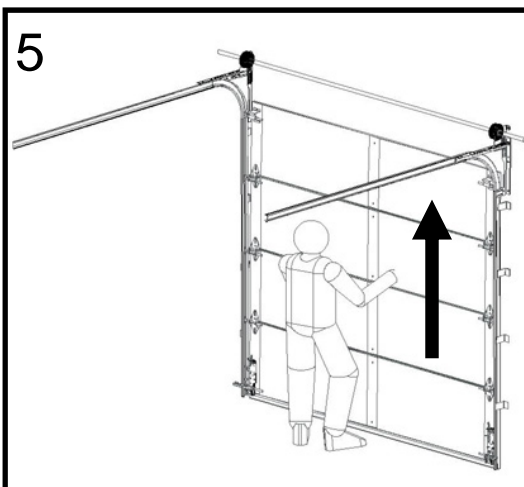
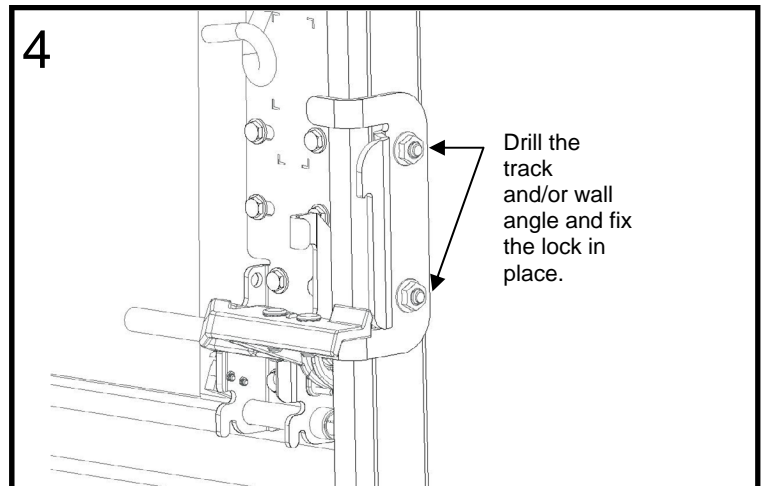
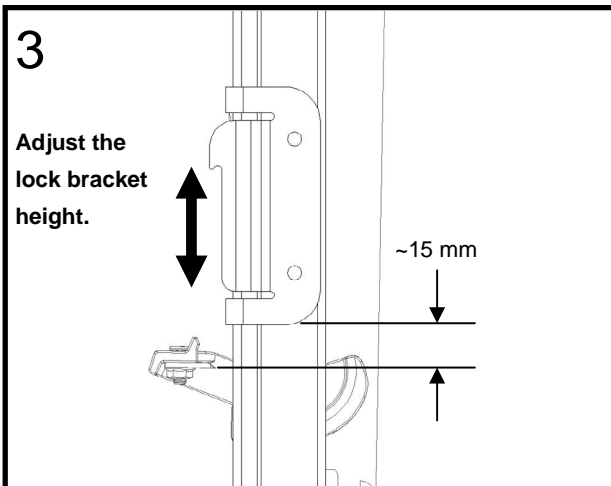
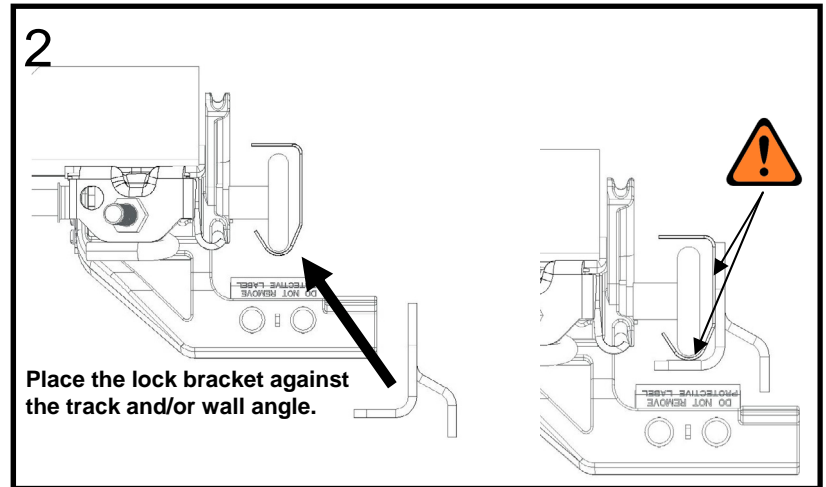
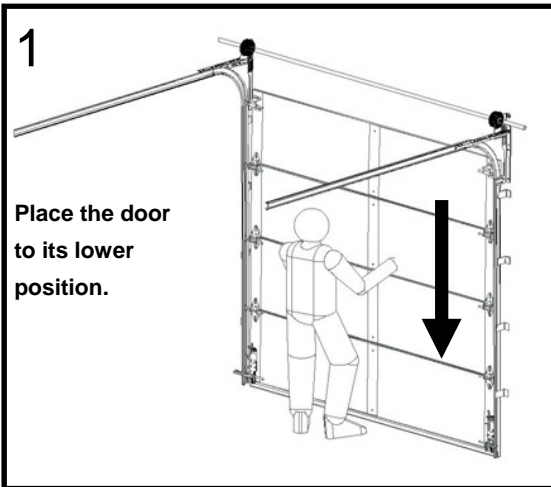

NOTE: The location of the lock is critical. Canimex cannot be held responsible for device misinstallation.

TRACKS SPECIFICATIONS

Right hand shown seen from bottom of the door

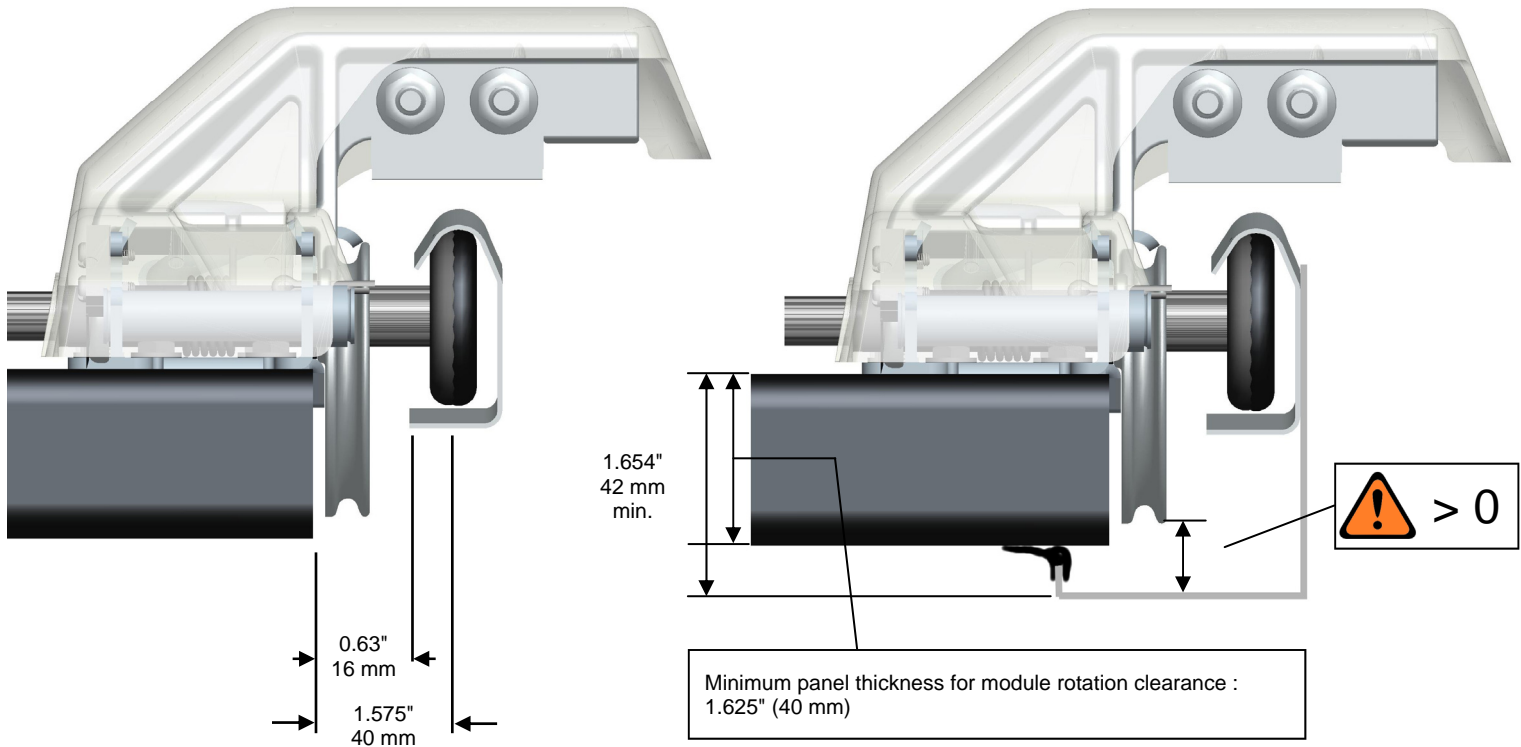

DOOR SIDE PLAY MUST NOT EXCEED 10 mm.

Track Spacing

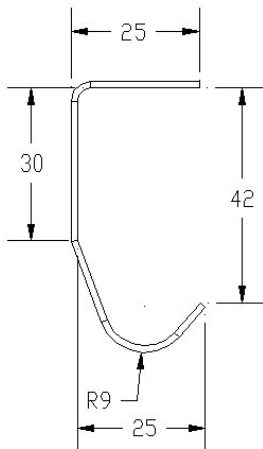

Track Specifications

Material: Steel;

~~STAINLESS STEEL~~

Maximum hardness allowed: 90 Rockwell B

Thickness: 1.25 to 2 mm (0.049" to 0.078")

BOLTING PATTERN OF SBB V3

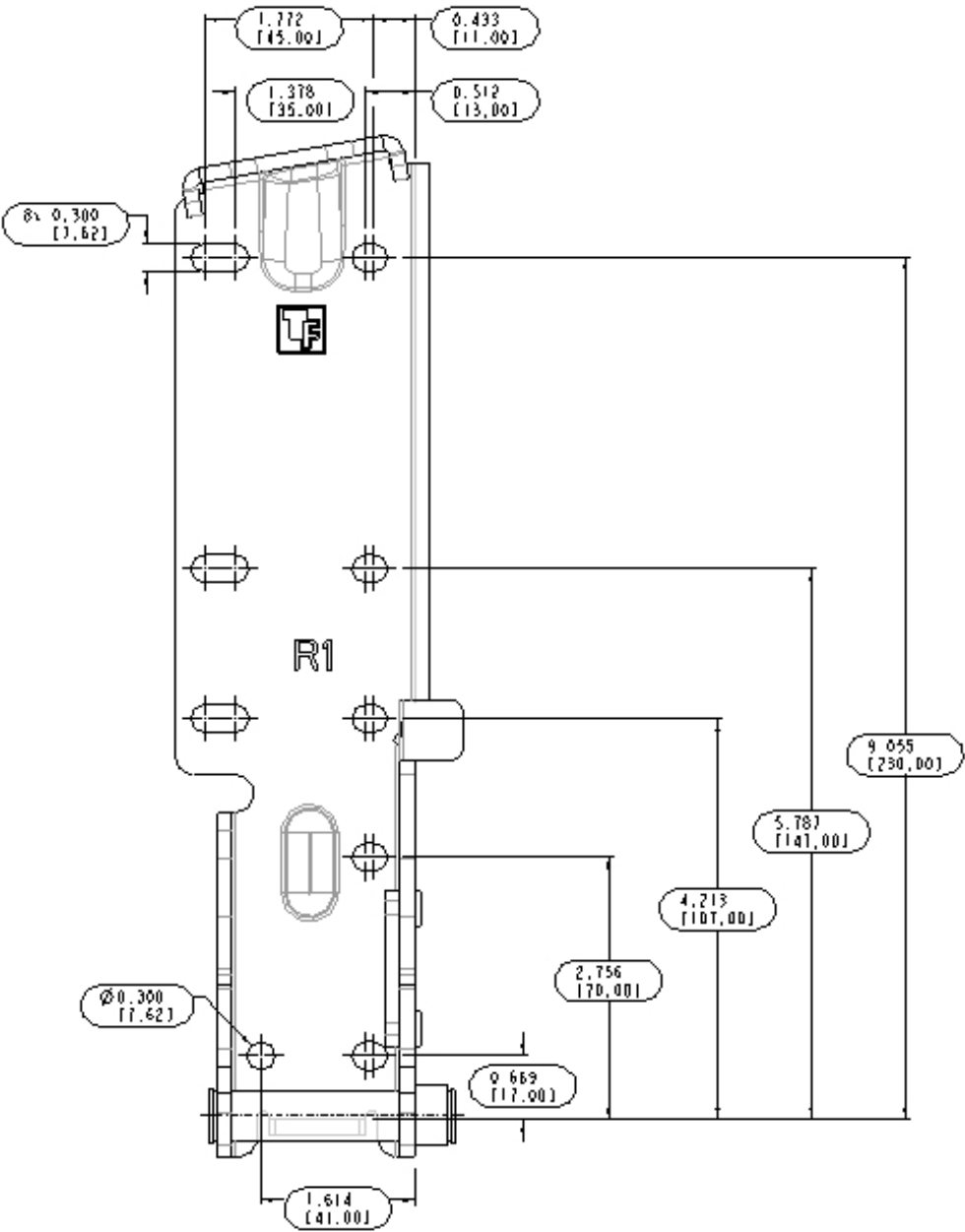

NOT TO SCALE

Right hand shown, left hand opposite

**inches
(mm)**



SERVICE PROCEDURE ONCE THE STOP BOTTOM BRACKET HAS BEEN ACTIVATED**WARNING:**

Only a qualified and experienced door technician can inspect the door. When the Stop Bottom Bracket activate, the door is not under normal operation condition.

PROCEDURE FOR THE USER OF THE DOOR:

- 1) Make sure ones will not be able to touch the door or pass under it. If the door is stopped on the vertical track, make sure to secure also the perimeter under the door.
- 2) Make sure no one can operate the door (electrically or hand operated).
- 3) Contact a qualified overhead door technician for the service.

PROCEDURE FOR THE TECHNICIAN:

- 1) Prevent the door from falling by supporting the door section (we recommend to use a forklift).
- 2) Lift slightly the door in order to free the blade.
- 3) Open up the rotating module and fix it in this position (there is a hole on the side of the rotating module specially design for this operation).
- 4) Perform a complete inspection of the door to make sure nothing can interfere the door lowering. Pay a special attention to the track, it could need to be repaired to be able to lower the door.
- 5) Lower the door to the floor.
- 6) Remove all the tension on the counterbalance system.
- 7) Remove the bottom bracket, mark it as used and non reusable part, and install the new one with the new cable using this installation guide.
- 8) Replace both cables even if only one cable broke.
- 9) Perform again a complete inspection of the door to make sure no other parts have been broken and need to be replaced. Replace or repair all damaged parts (roller, cable, etc.) before you install the counterbalancing system.
- 10) Reinstall the counterbalancing system.
- 11) Verify the door operation (electrically or hand operated).

NOTE:

If you don't have what is needed to repair the door, lower it to the ground, lock it and mark it as non functional. Also make sure the door cannot be operated (electrically or hand operated) by ones.



MAINTENANCE

Preventive maintenance must be scheduled on a yearly basis.

The following aspects must be inspected at installation then in a preventive maintenance program:

- 1) Make sure that the plastic cap is properly located. If not, or if the cap is damaged, you must investigate to make sure the product was not damaged by a collision that could potentially prevent it from working.
- 2) Clean up the Stop Bottom Bracket to prevent dirt or any other object to accumulate into the trajectory of the blade and rotation module. It must be able to rotate freely in the event of cable breakage.
- 3) Inspect the blade and the track to make sure there is no wear or damage on it. The red label over the blade must not have any visible wear.
- 4) Inspect the whole product to make sure there is no rust or corrosion or any other signs of material deterioration that could create undesired friction or similar behavior in the product.
- 5) Make sure the rotating module is under spring tension by removing any tension in the door cable.
- 6) Open the door until the Stop Bottom Brackets are located in the curves of the rails and ensure that there is no interference between the blades and the rails.
- 7) Test the limit switch system to ensure its functionality (OPTIONAL DEVICE).

If any of these inspections reveals a problem, contact a qualified overhead door technician as soon as possible and we suggest prohibiting the use of this door until the problem is fixed.

NOTES

Manufacturer cannot be held responsible for device misinstallation. If a functioning problem due to installation should happen, its cause needs to be found and solved.

MANUFACTURER:

Canimex Inc.
Torque Force division
285 St-Georges street
Drummondville (Québec) Canada
J2C 4H3
Tel: 819.477.1335
Fax: 819.477.0776
E-mail: torqueforce@canimex.com
Internet: www.canimex.com

