



Rail and Trolley Assembly

WARNING

To prevent **SERIOUS INJURY**:

- DO NOT connect power until instructed.
- Keep hands and fingers clear from sprocket during operation.
- Wear gloves when installing chain and cable.
- Keep hands and fingers away from joints and possible sharp edges.



CAUTION

- DO NOT connect power until instructed.
- To prevent **INJURY**, keep hands and fingers away from joints and possible sharp edges.
- Wear gloves when installing chain/belt and cable.

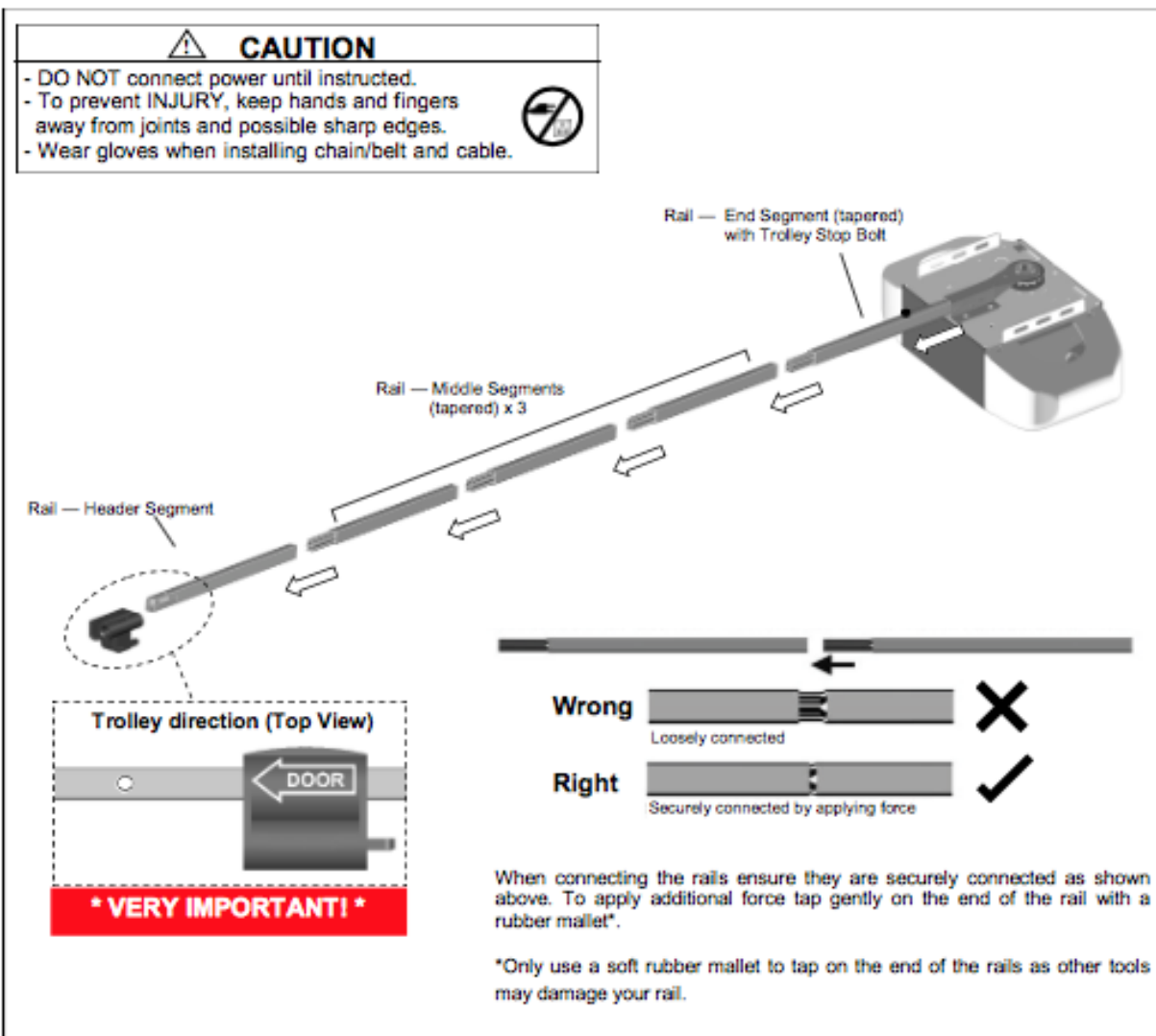

Fig.1

To Assemble Rail and Opener

1. Prepare the rails as shown in Fig.1.
2. Connect the rails starting with the Header Segment. Insert the tapered ends into open ends, apply any additional force necessary by tapping the Rail on padded flooring. Ensure the End Segment has Trolley Stop Bolt facing up. Make sure the rails are securely joined together as shown.
3. Slide the Trolley onto the rail from the Header Segment. Make sure the arrow is pointing towards the door as shown .
4. Connect the rail assembly to the Rail Bracket on the Opener.

Installing the Chain

WARNING

To prevent **SERIOUS INJURY**:

- DO NOT connect power until instructed.
- Keep hands and fingers clear from sprocket during operation.
- Wear gloves when installing chain/belt and cable.
- Keep hands and fingers away from joints and possible sharp edges.

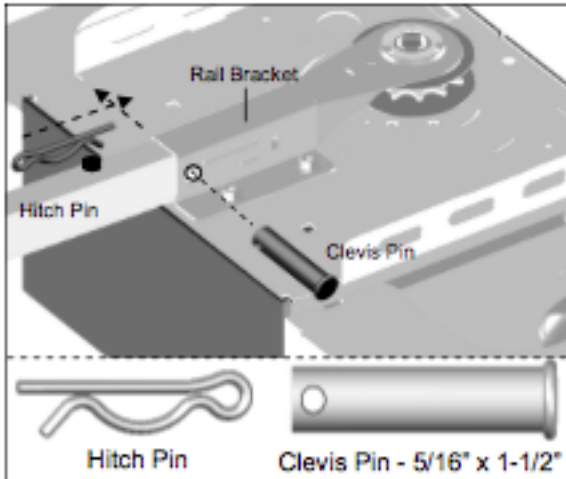

Fig.1

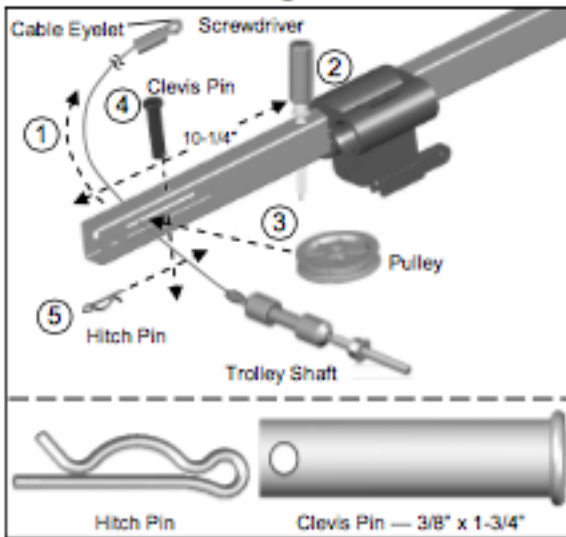

Fig.2

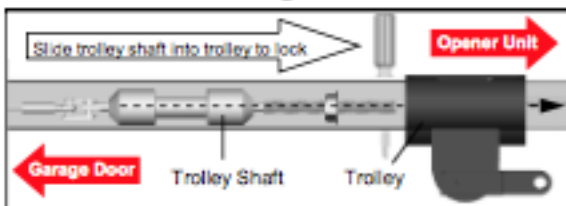

Fig.3

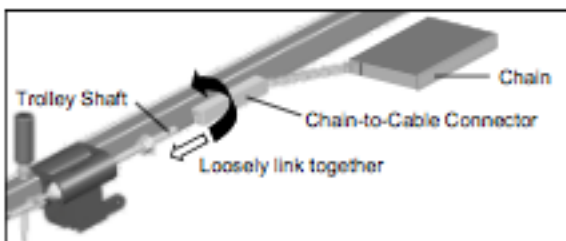

Fig.4

To Secure the Rail on the Opener

With the End Segment of the rail fully inserted into the Rail Bracket, insert a 5/16" x 1-1/2" Clevis Pin through the hole and lock it into position with a Hitch Pin as shown in Fig.1.

To Assemble the Header Section of Rail

Follow steps shown in Fig.2:

1. Remove the "Trolley Shaft and Cable" from the Chain carton and lay it beside the rail assembly. Hold Cable Eyelet on the end of cable and thread about 20" (50cm) through the slot on the Header Segment of the rail.
2. Insert a temporary screwdriver into the hole approximately 10-1/4" from the end of the Rail - Header Segment. Slide the trolley against this screw driver. The trolley must stay in this position for proper alignment of the chain.
3. Insert the Pulley into the opening while the cable is hanging.
4. Secure the Pulley by inserting the 3/8" x 1-3/4" Clevis Pin through the top of the rail.
5. Lock the Clevis Pin with a Hitch Pin. Rotate the Pulley to ensure it spins smoothly.

Slide the Trolley Shaft into the Trolley until a "click" is heard when they are connected and locked, as shown in Fig.3.

To Link Cable with Chain

Refer to Fig.4. Place the chain carton beside the rail, hold the "Chain to Cable Connector" and pull about 8" (20cm) of chain from the box. Thread the Chain to Cable Connector onto the Trolley Shaft so that they are loosely linked together.



NORTH SHORE
COMMERCIAL DOOR.COM

162 Edgewood Street • Elyria, Ohio 44035

www.northshorecommercialdoor.com

800 - 783 - 6112 • 440 - 365 - 3514