

IXIO-DT1

Activation & safety sensor
for automatic sliding doors



Download the BEA DECODER app
for a quick overview
of settings



DESCRIPTION

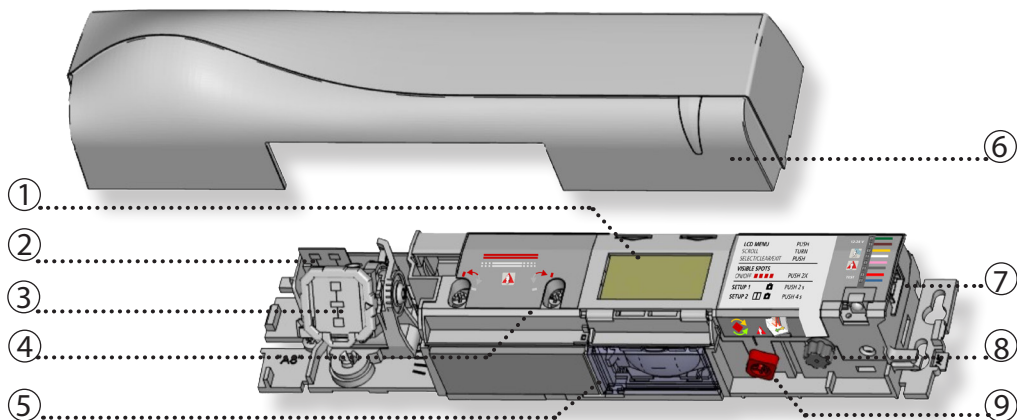

- | | |
|---------------------------------|-------------------------------------|
| 1. LCD | 6. cover |
| 2. radar antenna (narrow field) | 7. main connector |
| 3. radar antenna (wide field) | 8. main adjustment knob |
| 4. IR-curtain width adjustment | 9. IR-curtain angle adjustment knob |
| 5. IR-lenses | |

ACCESSORIES



10IMB: Bracket accessory

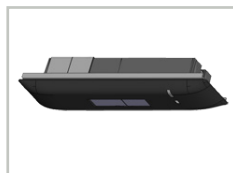

10ICA: Ceiling accessory

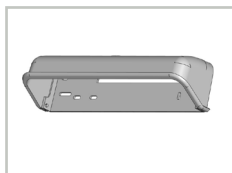

10IRA: Rain accessory

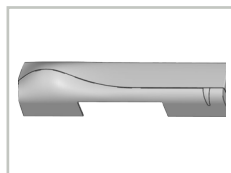

35.1286: black cover
35.1302: white cover
35.1303: silver cover

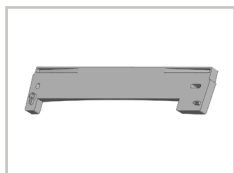

10CDA: Curved door accessory

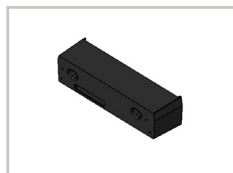

10IXIOSPACER: Spacer

1 MOUNTING & WIRING

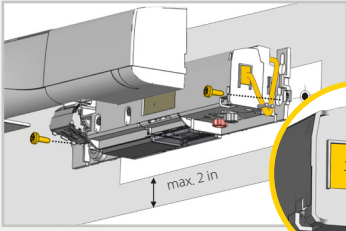

12-24 V AC, 50/60 Hz
12-35 V DC
Max 2.5 W

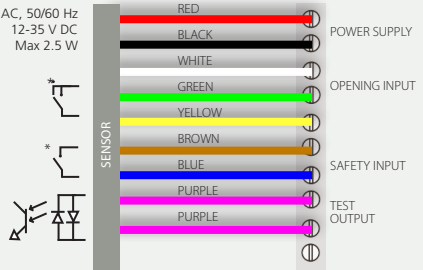

* Output status when sensor is operational

Mounting is compatible with the WIZARD.

Sensor connectivity (power and relays) must utilize only the supplied harness.

Sensor power must be supplied from a Class 2 supply source limited to 15 W.

Sensor is intended to be monitored for proper operation by the door operator or system.

Harness shall be routed separated from any Mains or non-Class 2 voltage cable for correct operation or shall be rated for the Mains voltage, and suitable protection and routing means shall be used according to National and Local Codes to prevent damage to the harness.

2 RADAR OPENING IMPULSE FIELD

ANGLE

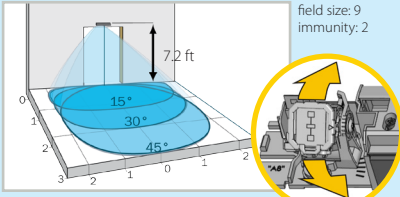

from 15° to 45°, default 30°

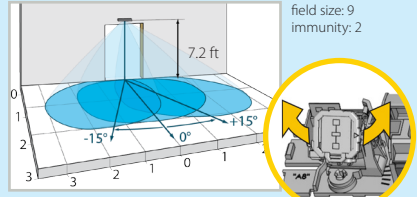

from -15° to 15°, default 0°

WIDTH

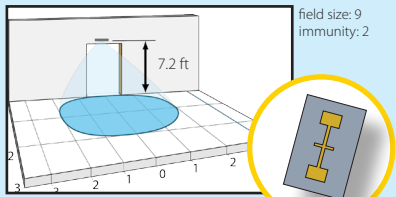

13 ft x 6.5 (wide)

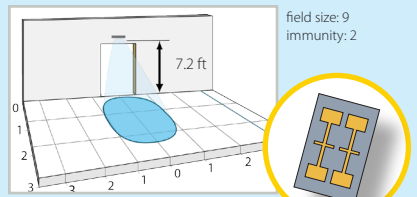

6.5 x 8 ft (narrow)

The size of the detection field varies according to the mounting height of the sensor.

3 INFRARED SAFETY FIELD

ANGLE

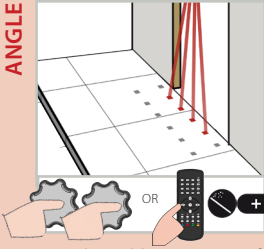

Activate the visible* spots to verify the position of the IR-curtain.

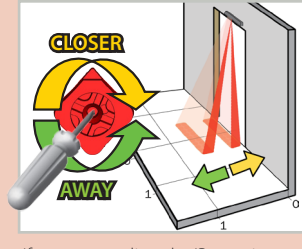

If necessary, adjust the IR-curtain angle (from -7° to 4° , default 0°).

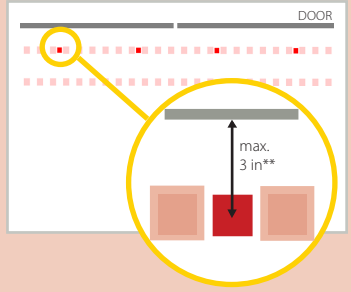

* Visibility depends on external conditions. When spots are not visible, use the Spotfinder to locate the curtains.
 ** The distance between the inner curtain of the inside door sensor and the inner curtain of the outside door sensor should always be smaller than 8 in.

WIDTH

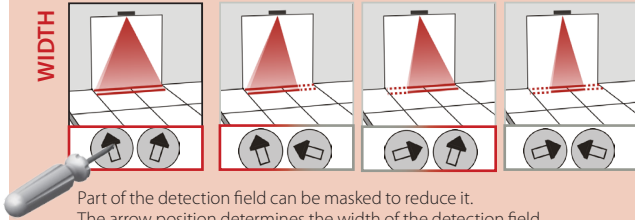

Part of the detection field can be masked to reduce it. The arrow position determines the width of the detection field.

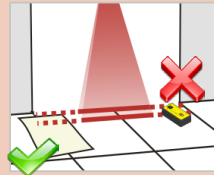

Always verify the actual detection field width with a piece of paper and not the Spotfinder, which detects the whole emitted field.

Additional adjustments are possible by LCD or remote control (see p. 5)

Mounting height	Detection width
6.5 ft	6.5 ft
7.2 ft	7.2 ft
8.2 ft	8.2 ft
9.8 ft	d max
11.5 ft	d max

The size of the detection field varies according to the mounting height and the settings of the sensor. The full door width must be covered.

4 SETUP



STEP OUT OF THE INFRARED FIELD!



OR



SETUP 1 (QUICK)

reference picture



SETUP 2 (ASSISTED)

test of full door cycle + reference picture



TEST THE PROPER OPERATION OF THE INSTALLATION BEFORE LEAVING THE PREMISES!

HOW TO USE THE LCD?

DISPLAY DURING NORMAL FUNCTIONING

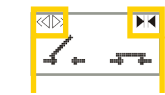

Activation impulse Safety impulse



Negative display = active output



To adjust contrast, push and turn the grey button simultaneously.
During normal function only.

FACTORY VALUE VS. SAVED VALUE



displayed value = factory value



displayed value = saved value

NAVIGATING IN MENUS



Push to enter the LCD-menu



Enter password if necessary

Not during the first minute after power-on of the sensor.



Select your language before entering the first LCD-menu.

During the first 30 seconds after power-on of the sensor or later in the diagnostics menu.



Scroll menu items



Select **Back** to return to previous menu or display.



Select **More** to go to next level:
- basic settings
- advanced settings
- diagnostics

CHANGING A VALUE



Scroll menu up-down



Push to select parameter

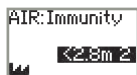

current value is displayed



Scroll values up-down

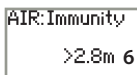

more values are displayed



Push to save new value



new value is displayed

CHANGING A ZIP CODE



See application note on ZIP CODE

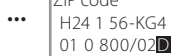

...

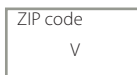
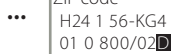

Validate the last digit in order to activate the new ZIP code:

- v = valid ZIP code, values will be changed accordingly
- x = invalid ZIP code, no values will be changed
- v/x = valid ZIP code, but from a different product.

Only available values will be changed.

VALUE CHECK WITH REMOTE CONTROL

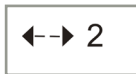



















Pressing a parameter symbol on your remote control, displays the saved value directly on the LCD-screen. Do not unlock first.

OVERVIEW OF SETTINGS

	0	1	2	3	4	5	6	7	8	9	
BASIC											
Back More											
RAD: FIELD SIZE	small	>	>	>	>	>	>	>	>	large	
IR: WIDTH									Always additionally adjust the arrow position on the sensor with a screwdriver.		
IR: OUTPUT	DeEner/NO Energ/NC		Energ/NC DeEner/NO		Energ/NC Energ/NC		DeEner/NC DeEner/NC		DeEner: De-Energized relay Energ: Energized relay		NO: normally open NC: normally closed
TEST	off	on									
More Back											
Back More											
ADVANCED											
RAD: FIELD SIZE	small	>	>	>	>	>	>	>	>	large	
RAD: IMMUNITY		low	>	>	>	>	>	>	>	high	
RAD: DIRECTION	off	bi	uni	uni MTF	uni away	MTF: motion tracking feature					
RAD: HOLD TIME	0.5 s	1 s	2 s	3 s	4 s	5 s	6 s	7 s	8 s	9 s	
RAD: REENTRY	small	>	>	>	>	>	>	>	>	large	
RAD: OUTPUT	DeEner/NO Energ/NC		Energ/NC DeEner/NO		Energ/NC Energ/NC		DeEner/NC DeEner/NC		DeEner: De-Energized relay Energ: Energized relay		NO: normally open NC: normally closed
IR: IMMUNITY		normal	enhanced				mode B				
IR: WIDTH									Always additionally adjust the arrow position on the sensor with a screwdriver.		
IR: NUMBER	service mode	1	2	service mode = no IR detection during 15 minutes (maintenance). This value excludes conformity of the door system to EN 16005 and DIN 18650.							
IR: PRESENCE TIME			30 s	1 min	2 min	5 min	10 min	20 min	60 min	infinite	min. value for DIN 18650: 1 min min. value for EN 16005: 30 s
IR: FREQ		A	B								
IR: OUTPUT	DeEner/NO Energ/NC		Energ/NC DeEner/NO		Energ/NC Energ/NC		DeEner/NC DeEner/NC		DeEner: De-Energized relay Energ: Energized relay		NO: normally open NC: normally closed
TEST	off	on									
REDIRECTION	motion	motion or presence	motion and presence	opening output is active in case of:							0 motion detection 1 motion or presence detection 2 motion and presence detection
FACTORY RESET									full reset	partial reset	partial: outputs are not reset
More Back											
Back More											
DIAGNOSTICS											
ZIP CODE	all parameter settings in zipped format (see application note on ZIP CODE)										
ID #	unique ID-number										
CONFIG P/N											
SOFT P/N											
ERROR LOG	last 10 errors + day indication										
IR: SPOTVIEW	view of spot(s) that trigger detection										
	75.5751.07 IXIO-DT1 UL 20160218										

- IR: C1 ENERG *signal amplitude received on curtain 1*
- IR: C2 ENERG *signal amplitude received on curtain 2*
- POWERSUPPLY *supply voltage at power connector*
- OPERATINGTIME *power duration since first startup*
- RESET LOG *delete all saved errors*
- PASSWORD *LCD and remote control password
(0000=no password)*
- ADMIN *enter code to access admin mode*

TROUBLESHOOTING

E1	 ORANGE LED flashes 1 x.	The sensor signals an internal fault.	<ol style="list-style-type: none"> 1 Replace sensor.
E2	 ORANGE LED flashes 2 x.	The power supply is too low or too high.	<ol style="list-style-type: none"> 1 Check power supply (in the diagnostics menu of the LCD). 2 Check wiring.
E4	 ORANGE LED flashes 4 x.	The sensor receives not enough IR-energy.	<ol style="list-style-type: none"> 1 Decrease the angle of the IR-curtains. 2 Increase the IR-immunity filter. 3 Deactivate 1 curtain.
E5	 ORANGE LED flashes 5 x.	The sensor receives too much IR-energy.	<ol style="list-style-type: none"> 1 Slightly increase the angle of the IR-curtains. 2 Decrease the IR-immunity filter.
E8	 ORANGE LED flashes 8 x.	The sensor is disturbed by external elements.	<ol style="list-style-type: none"> 1 Eliminate the cause of disturbance (lamps, rain cover, door controller housing properly grounded).
	 ORANGE LED is on.	IR power emitter is faulty.	<ol style="list-style-type: none"> 1 Replace sensor.
	 RED LED flashes quickly after an assisted setup.	The sensor encounters a memory problem.	<ol style="list-style-type: none"> 1 Cut and restore power supply. 2 If orange LED lights up again, replace sensor.
	 RED LED flashes quickly after an assisted setup.	The sensor sees the door during the assisted setup.	<ol style="list-style-type: none"> 1 Move the IR-curtains away from the door. 2 Install the sensor as close to the door as possible. If needed, use a bracket accessory. 3 Launch a new assisted setup.
	 RED LED lights up sporadically.	The sensor vibrates.	<ol style="list-style-type: none"> 1 Check if the sensor is fastened firmly. 2 Check position of cable and cover.
	 RED LED lights up sporadically.	The sensor sees the door.	<ol style="list-style-type: none"> 1 Launch an assisted setup and adjust the IR angle.
	 RED LED lights up sporadically.	The sensor is disturbed by external conditions.	<ol style="list-style-type: none"> 1 Increase the IR-immunity filter.
	 GREEN LED lights up sporadically.	The sensor is disturbed by rain and/or leaves.	<ol style="list-style-type: none"> 1 Increase radar-immunity filter.
	 GREEN LED lights up sporadically.	Ghosting created by door movement.	<ol style="list-style-type: none"> 1 Change radar field angle.
	 GREEN LED lights up sporadically.	The sensor vibrates.	<ol style="list-style-type: none"> 1 Check if the sensor and door cover is fastened firmly. 2 Check position of cable and cover.
	 GREEN LED lights up sporadically.	The sensor sees the door or other moving objects.	<ol style="list-style-type: none"> 1 Remove the objects if possible. 2 Change radar field size or angle.
	 The LED and the LCD-display are off.		<ol style="list-style-type: none"> 1 Check wiring.
	 The LED and the LCD-display are off.	The reaction of the door does not correspond to the LED-signal.	<ol style="list-style-type: none"> 1 Check output configuration setting. 2 Check wiring.
	 The LCD or remote control does not react.	The sensor is protected by a password.	<ol style="list-style-type: none"> 1 Enter the right password. If you forgot the code, cut and restore the power supply to access the sensor without entering a password during 1 minute.

- IXIO sensors are intended to be used with pedestrian sliding door systems.
- This device can be expected to comply with Part 15 of the FCC Rules provided it is assembled in exact accordance with the instructions provided with this kit. Operation is subject to the following conditions: (1) this device may not cause harmful interference, and (2) this device must accept any interference received including interference that may cause undesired operation.

LED-SIGNAL



Motion detection



Presence detection



LED flashes



LED flashes x times



LED flashes red-green



LED flashes quickly



LED is off

INSTALLATION



The sensor should be mounted firmly to avoid extreme vibrations.

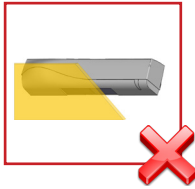

Do not cover the sensor.



Avoid moving objects and light sources in the detection field.

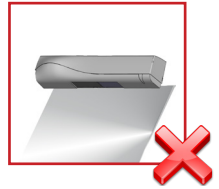

Avoid highly reflective objects in the infrared field.

MAINTENANCE

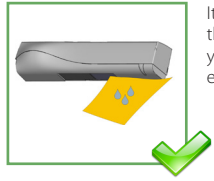

It is recommended to clean the optical parts at least once a year or more if required due to environmental conditions.



Do not use aggressive products to clean the optical parts.

SAFETY

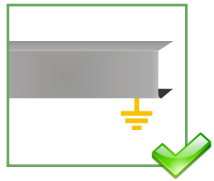

The door control unit and the door cover profile must be correctly earthed.

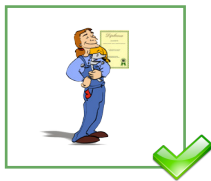

Only trained and qualified personnel may install and setup the sensor.

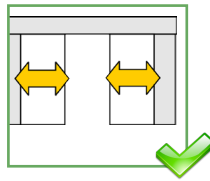

Always test the proper operation of the installation before leaving the premises.

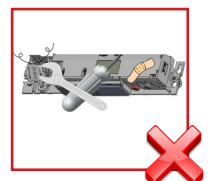

The warranty is invalid if unauthorized repairs are made or attempted by unauthorized personnel.



- The device cannot be used for purposes other than its intended use. All other uses cannot be guaranteed by the manufacturer of the sensor.
- The manufacturer of the door system is responsible for carrying out a risk assessment and installing the sensor and the door system in compliance with applicable national and international regulations and standards on door safety.
- The manufacturer of the sensor cannot be held responsible for incorrect installations or inappropriate adjustments of the sensor.

TECHNICAL SPECIFICATIONS

Supply voltage:	12 V - 24 V AC +/-10% ; 12 V - 30 V DC +/-10% (to be operated from SELV compatible power supplies only)
Power consumption:	< 2.5 W
Mounting height:	6.5 ft to 11.5 ft (local regulations may have an impact on the acceptable mounting height)
Temperature range:	-13°F to +131°F; 0-95% relative humidity, non condensing
Degree of protection:	IP54
Noise:	< 70 dB
Expected lifetime:	20 years
Applicable directives:	R&TTE 1999/5/EC; MD 2006/42/EC; LVD 2006/95/EC; ROHS 2 2011/65/EU



Detection mode:	Motion Min. detection speed: 2 in/s	Presence Typical response time: < 200 ms (max. 500 ms)
Technology:	Microwave doppler radar Transmitter frequency: 24.150 GHz Transmitter radiated power: < 20 dBm EIRP Transmitter power density: < 5 mW/cm²	Active infrared with background analysis Spot: 2 in x 2 in (typ) Number of spots: max. 24 per curtain Number of curtains: 2
Output:	Electro-mechanical-relay (potential and polarity free) Max. contact current: 1 A Max. contact voltage: 30 V DC Adjustable Holdtime: 0.5 to 9 s	Solid-state-relay (potential and polarity free) Max. contact current: 400 mA Max. contact voltage: 42 V AC/DC Holdtime: 0.3 to 1 s
Test input:		Sensitivity: Low: < 1 V; High: > 10 V (max. 30 V) Response time on test request: typical: < 5 ms
Norm conformity:		EN 12978 EN ISO 13849-1:2008 PL «C» CAT. 2 (under the condition that the door control system monitors the sensor at least once per door cycle) IEC 61496-1:2012 ESPE Type 2 EN 16005:2012 Chapter 4.6.8; DIN 18650-1:2010 Chapter 5.7.4 BS 7036-1:1996 Chapter 8.1

Specifications are subject to changes without prior notice.
All values measured in specific conditions.

ANSI / AAADM Compliance



Upon completion of the installation or service work, at a minimum, perform a daily safety check in accordance with the minimum inspection guidelines provided by AAADM. Provide each equipment owner with an owner's manual that includes a daily safety checklist and contains, at a minimum, the information recommended by AAADM. Offer an information session with the equipment owner explaining how to perform daily inspections and point out the location of power/operation switches to disable the equipment if a compliance issue is noted. The equipment should be inspected annually in accordance with the minimum inspection guidelines. A safety check that includes, at a minimum, the items listed on the safety information label must be performed during each service call. If you are not an AAADM certified inspector, BEA strongly recommends you have an AAADM certified inspector perform an AAADM inspection and place a valid inspection sticker below the safety information label prior to putting the equipment into operation.



BEA hereby declares that the IXIO-DT1 is in conformity with the basic requirements and the other relevant provisions of the directives 1999/5/EC, 2006/95/EC and 2006/42/EC.

Notified Body for EC-type inspection: 0044 - TÜV NORD CERT GmbH, Langemarckstr. 20, D-45141 Essen

EC-type examination certificate number: 44 205 12 405836-001

Angleur, October 2014 Pierre Gardier, authorized representative and responsible for technical documentation

The complete declaration of conformity is available on our website: www.bea-pedestrian.be

Only for EC countries: According to the European Guideline 2012/19/EU for Waste Electrical and Electronic Equipment (WEEE)

