

Dimensions

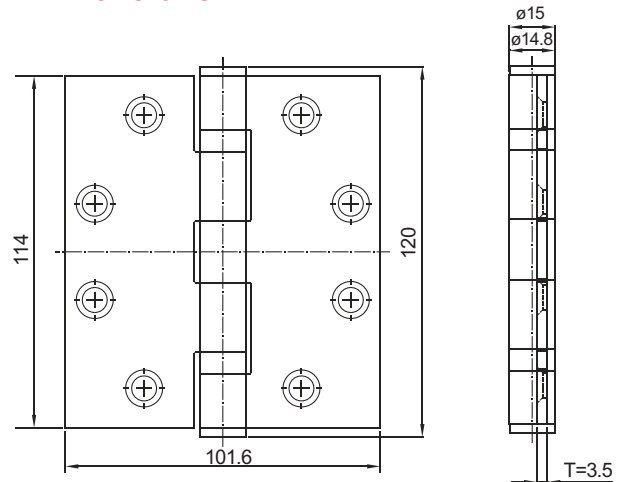

Unit: mm

Statement

The Electric Power Transfer Hinge is a wire protector with the function of power conveying during electric device installation. Stainless Steel housing provide the concealed wires between the door and the frame.

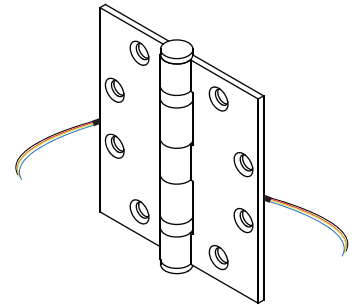

Features

- Voltage application: 12/24 VDC
- Current draw: 1A per pair , Max. at 2A
Red/Black: +/-
Blue/Yellow: COM / N.O.
Green/White: COM / N.O.
- Wires: 0.28mm
- Power and signal transfer by
4 conductors, length 170mm (DL-104)
6 conductors, length 200mm (DL-106)
- Stainless steel
- Dimension: 4 1/2" x 4" x 3.5 mm
- Net weight: 382g

Application

The electric power transfer hinge gives attractive and neat result for the wiring.



Warranty

The product is warranted against defects in material and workmanship while used in normal service for a period of 1 year from the date of sale to the original client. The Transmitter Solutions is one of continual development and improvement; therefore Transmitter Solutions reserves the right to change specifications without notice.