



**STANDARD
WEATHERPROOF
ELECTROMAGNETIC LOCK**

INSTALLATION MANUAL

Optional Bracket

Brackets installation are according to door swing direction and door frame type , e.g. narrow frame door , frameless glass door , inswing door , etc.

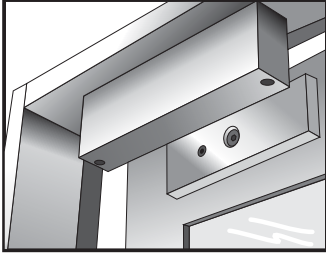

Regular Installation
(outswinging door)

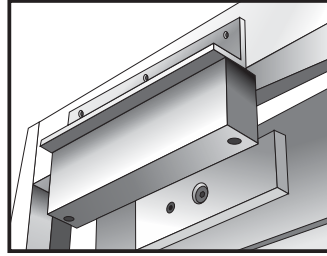

L-bracket for
narrow frames (optional)

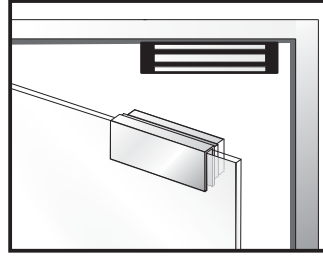

U-bracket for frameless
glass doors (optional)

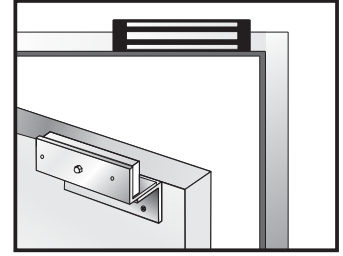

LZ-bracket for
inswing doors (optional)

Regular Installation

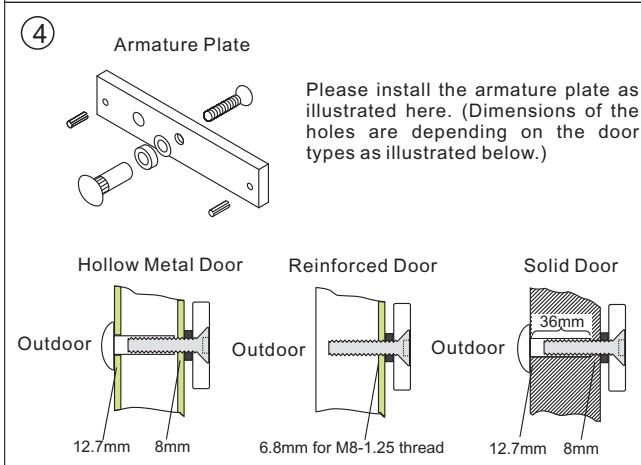
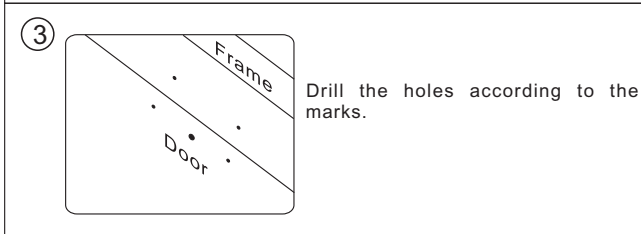
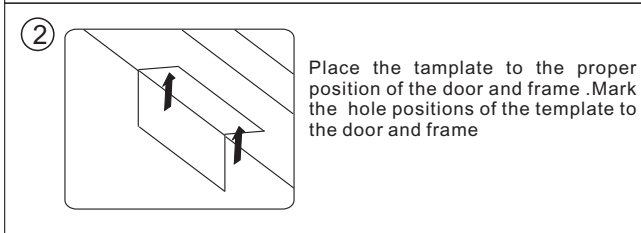
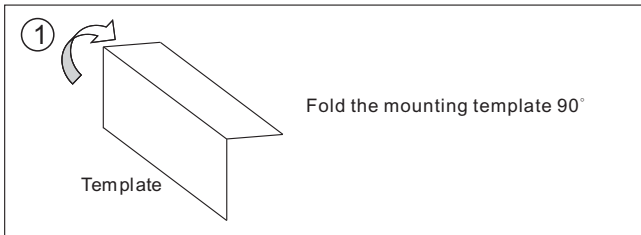

Drill a Ø8mm hole through door, on closing side enlarge to Ø12.7mm by a sexnut blot on the opening side.

Drill a Ø6.8mm hole and tap on closing side a M8x12.5 thread.

Drill a Ø8mm hole through door on closing side enlarge to Ø 12.7mm, by a sexnut blot on the opening side. The depth is 36mm.

Recommendation:

- (300 LBS), maximum thickness of door is 44 mm.
- (600 LBS), maximum thickness of door is 50 mm.
- (800 LBS), maximum thickness of door is 48 mm.
- (1200 LBS), maximum thickness of door is 46 mm.

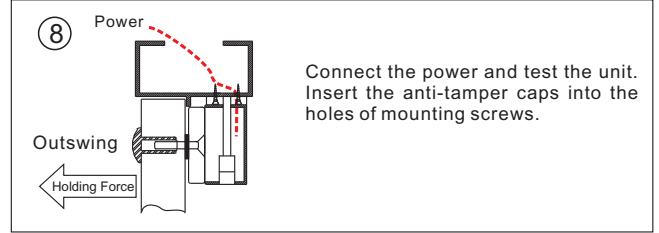
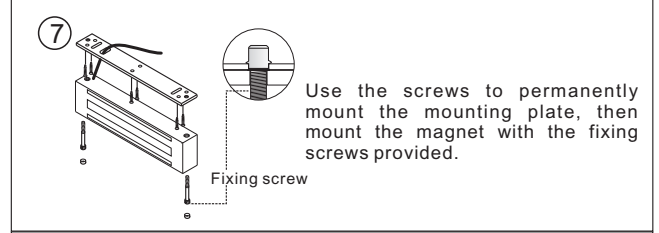
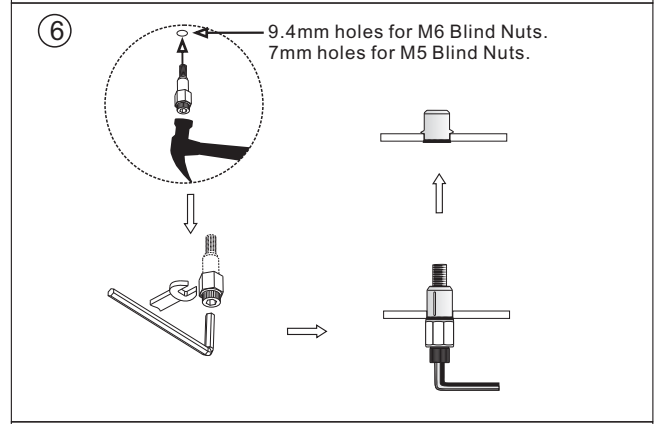
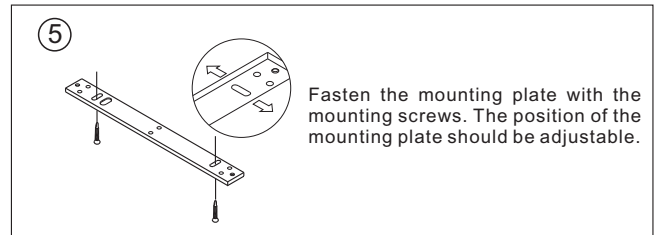

Butt Splice (IDC) Connector

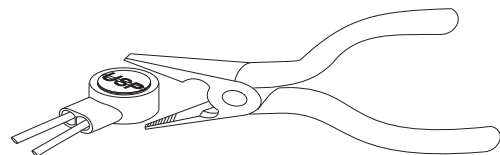

Using crimper or pliers and pressing the header of connector down to even position.

LZ or Z bracket for inswing doors

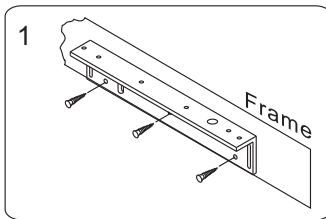

Find a mounting position on the door frame for the L bracket. Make sure that the door is still closeable.

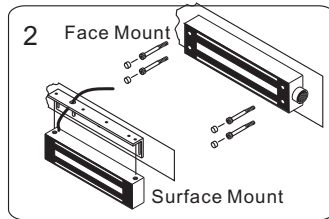

Use the fixing bolts to tighten the electromagnetic lock on L bracket. (For facemount, the magnetic lock can be mounted directly on the door frame)

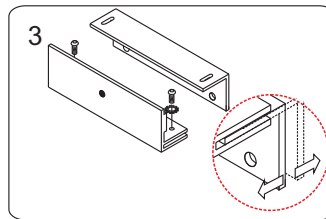

Assemble the Z bracket, and make sure that the Z bracket is adjustable.

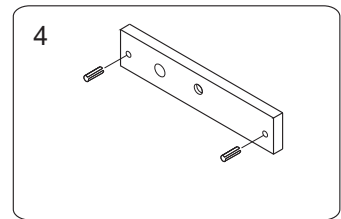

Insert the guide pins into the armature plate.

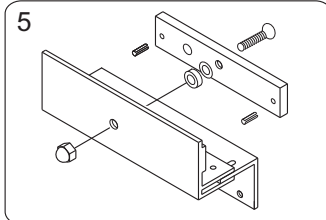

Fasten the armature plate to the Z bracket (Must add rubber washer)

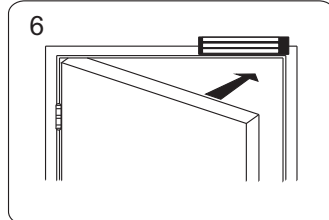

Close the door and connect the power

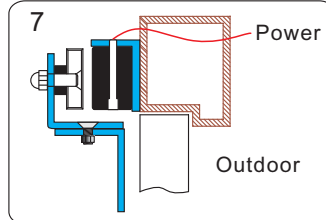

After the maglock attracts the armature adjust plate, the Z bracket to fit the door.

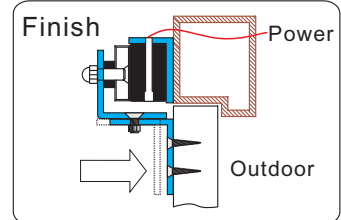

Fasten the Z bracket to the door.

Connecting Diagram

Wire Leads	Voltage	Bond sensor output
2C Wire Leads Single voltage (Power input is polarity free)	<p>12 VDC: Black, Red</p> <p>24 VDC: Black, White</p>	
4C Wire Leads: Dual voltage (Power input is polarity free)	<p>Voltage Selection: 12 VDC</p> <p>Voltage Selection: 24 VDC</p>	
5C Wire Leads Bond Sensor Output (Power input is polarity free)		<p>Bond sensor output Indicates the locked (N.O. contact) or unlocked (N.C. contact) status (Relay rated 0.5/20VDC)</p> <p>White:N.C. Black:COM. Red:N.O.</p>
6C Wire Leads Dual voltage and Bond Sensor Output (Power input is polarity free)	<p>Voltage Selection: 12 VDC</p> <p>Voltage Selection: 24 VDC</p>	<p>Bond sensor output Indicates the locked (N.O. contact) or unlocked status (N.C. contact) (Relay rated 0.5A/20VDC)</p> <p>Blue:COM. Yellow:N.O.</p>
7C Wire Leads Dual voltage and Bond Sensor Output (Power input is polarity free)	<p>Voltage Selection: 12 VDC</p> <p>Voltage Selection: 24 VDC</p>	<p>Bond sensor output Indicates the locked (N.O. contact) or unlocked status (N.C. contact) (Relay rated 0.5A/20VDC)</p> <p>Brown:N.C. Blue:COM. Yellow:N.O.</p>

WARRANTY:

The warranty period of Transmitter Solutions magnetic locks is twenty-four (24) months. This warranty shall begin on the date the keypad is manufactured. During the warranty period, the product will be repaired or replaced (at the sole discretion of Transmitter Solutions) if the product does not operate correctly due to a defective component. This warranty does not extend to (a) the case, which can be damaged by conditions outside the control of Transmitter Solutions, or (b) battery life. This warranty is further limited by the following disclaimer of warranty and liability:

EXCEPT AS SET FORTH ABOVE, TRANSMITTER SOLUTIONS MAKES NO WARRANTIES REGARDING THE GOODS, EXPRESS OR IMPLIED, INCLUDING WARRANTY OF MERCHANTABILITY OR WARRANTY OF FITNESS FOR A PARTICULAR PURPOSE. BUYER MAKES NO RELIANCE ON ANY REPRESENTATION OF TRANSMITTER SOLUTIONS, EXPRESS OR IMPLIED, WITH REGARD TO THE GOODS AND ACCEPTS THEM "AS-IS/WHERE-IS". TRANSMITTER SOLUTIONS SELLS THE GOODS TO BUYER ON CONDITION THAT TRANSMITTER SOLUTIONS WILL HAVE NO LIABILITY OF ANY KIND AS A RESULT OF THE SALE. BUYER AGREES THAT TRANSMITTER SOLUTIONS SHALL HAVE NO LIABILITY FOR DAMAGES OF ANY KIND, WHETHER DIRECT, INCIDENTAL OR CONSEQUENTIAL DAMAGES, INCLUDING INJURIES TO PERSONS OR PROPERTY, TO BUYER, ITS EMPLOYEES OR AGENTS, AS A RESULT OF THE SALE. BUYER ALSO AGREES TO HOLD TRANSMITTER SOLUTIONS HARMLESS FROM ANY CLAIMS BUYER, OR ANY THIRD PARTY, MAY HAVE AS A RESULT OF BUYER'S USE OR DISPOSAL OF THE GOODS. BUYER HAS READ THIS DISCLAIMER AND AGREES WITH ITS TERMS IN CONSIDERATION OF RECEIVING THE GOODS.



7380 S. Eastern Avenue, Suite 124-320 • Las Vegas, NV 89123
(866) 975-0101 * (866) 975-0404 Fax
www.transmittersolutions.com